

LASERTRON (12' 4" TALL) KRAZY AXES VIP STANDARD AND **UPGRADED** FURNITURE PACKAGES

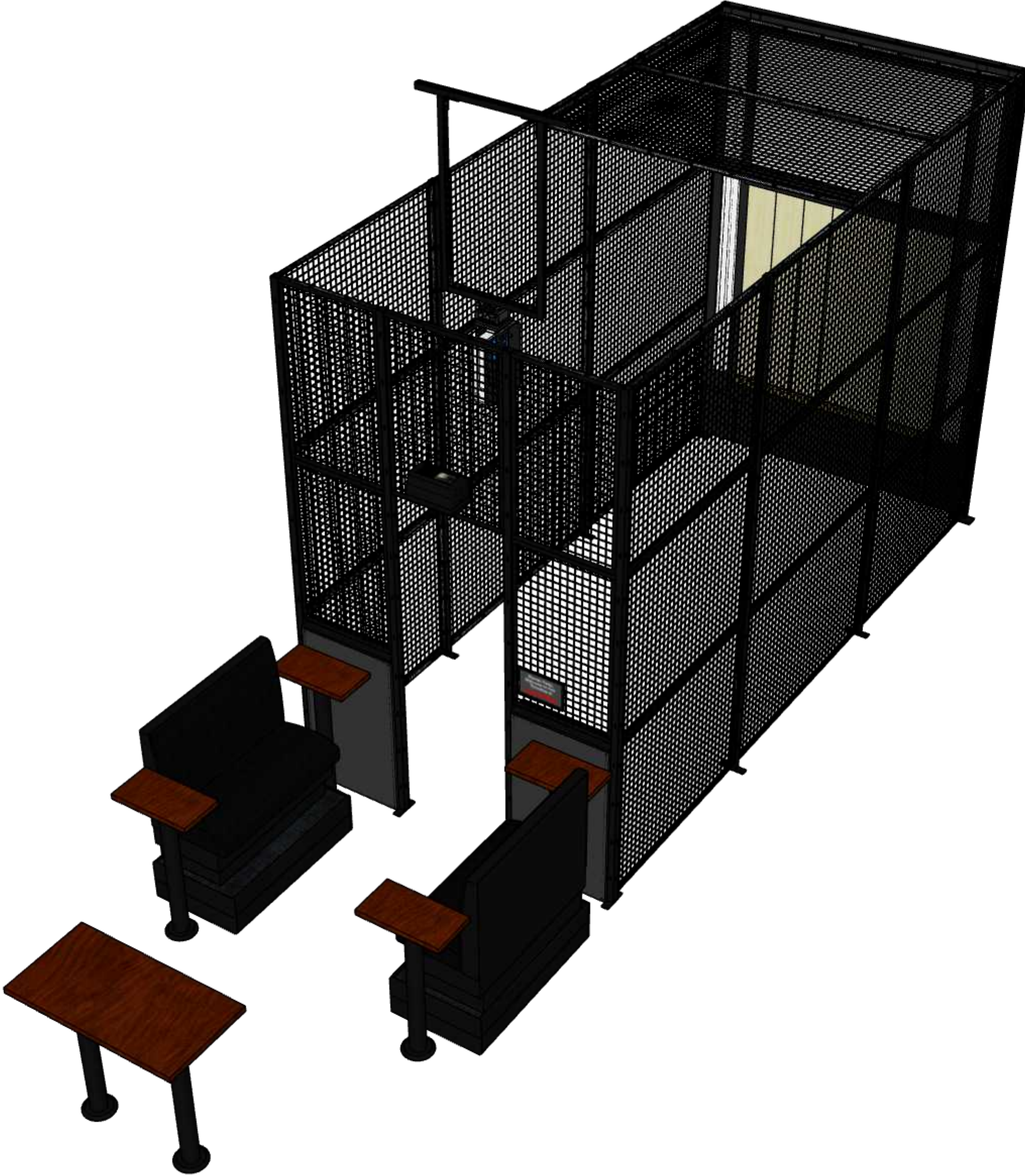

STANDARD FURNITURE PACKAGE

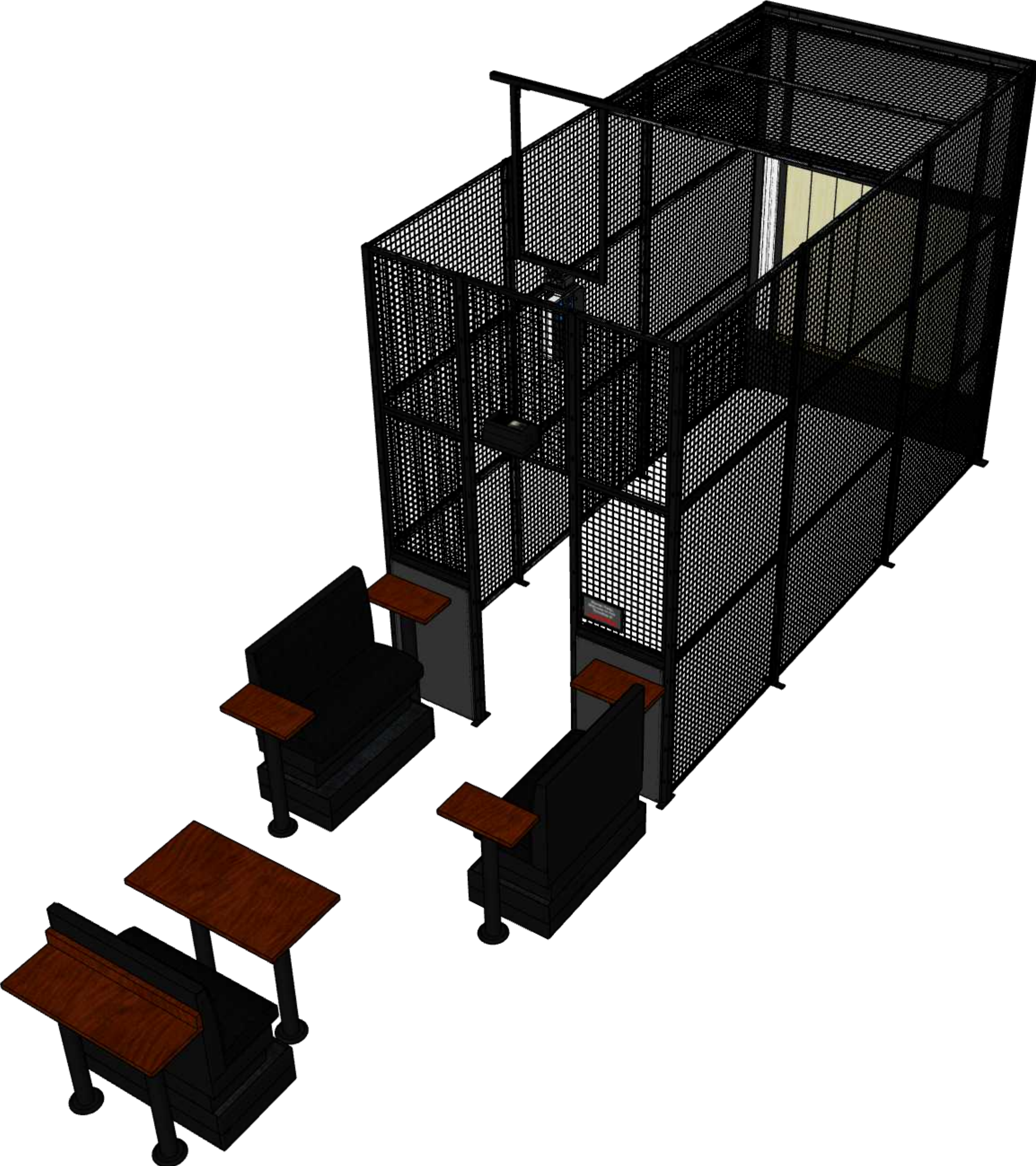

UPGRADED FURNITURE PACKAGE

PERSPECTIVE VIEW

THIS DOCUMENT IS THE PROPERTY OF LASERTRON, INC. AND HAS BEEN PREPARED AND ISSUED FOR A SPECIFIC PROJECT AS MARKED ON THIS DOCUMENT. THE RECIPIENT BY ACCEPTING THIS DOCUMENT ASSUMES CUSTODY AND AGREES THAT THIS DOCUMENT WILL NOT BE COPIED OR REPRODUCED IN PART OR IN WHOLE. ALL SPECIAL FEATURES OF THIS DESIGN SHALL NOT BE INCORPORATED IN ANY OTHER PROJECT, UNLESS THE PRIOR WRITTEN AGREEMENT OF LASERTRON HAS BEEN OBTAINED. THIS DOCUMENT WILL BE RETURNED UPON THE COMPLETION OF THE PROJECT CONTEMPLATED BY THE DOCUMENTS OR UPON THE REQUEST OF LASERTRON. THIS DOCUMENT IS THE EXCLUSIVE PROPERTY OF LASERTRON, NO RIGHTS TO OWNERSHIP ARE TRANSFERABLE, OR SHALL BE LOST BY THE FILING OF THIS DOCUMENT WITH ANY AND ALL PUBLIC AUTHORITIES FOR ANY PURPOSES.

- KRAZY AXES VIP REQUIRES A MINIMUM OF 12' 6" CLEAR HEIGHT (DEPENDING ON CLEAR HEIGHT, SHORTER AXE LANES MAY BE AVAILABLE)
- KRAZY AXES VIP REQUIRES A MINIMUM OF 2" TO THE RIGHT AND LEFT OF THE LANES FOR INSTALLATION.
- THE 2" IS MEASURED FROM THE EDGE OF THE BASE PLATE TO THE NEAREST WALL.
- KRAZY AXES VIP TYPICALLY INSTALLED TIGHT TO BACK WALL.
- KRAZY AXES VIP LANES CAN BE OVERLAPPED TO CREATE 3-LANE, 4-LANE, 5-LANE, ETC...SIDE BY SIDE CONFIGURATIONS.

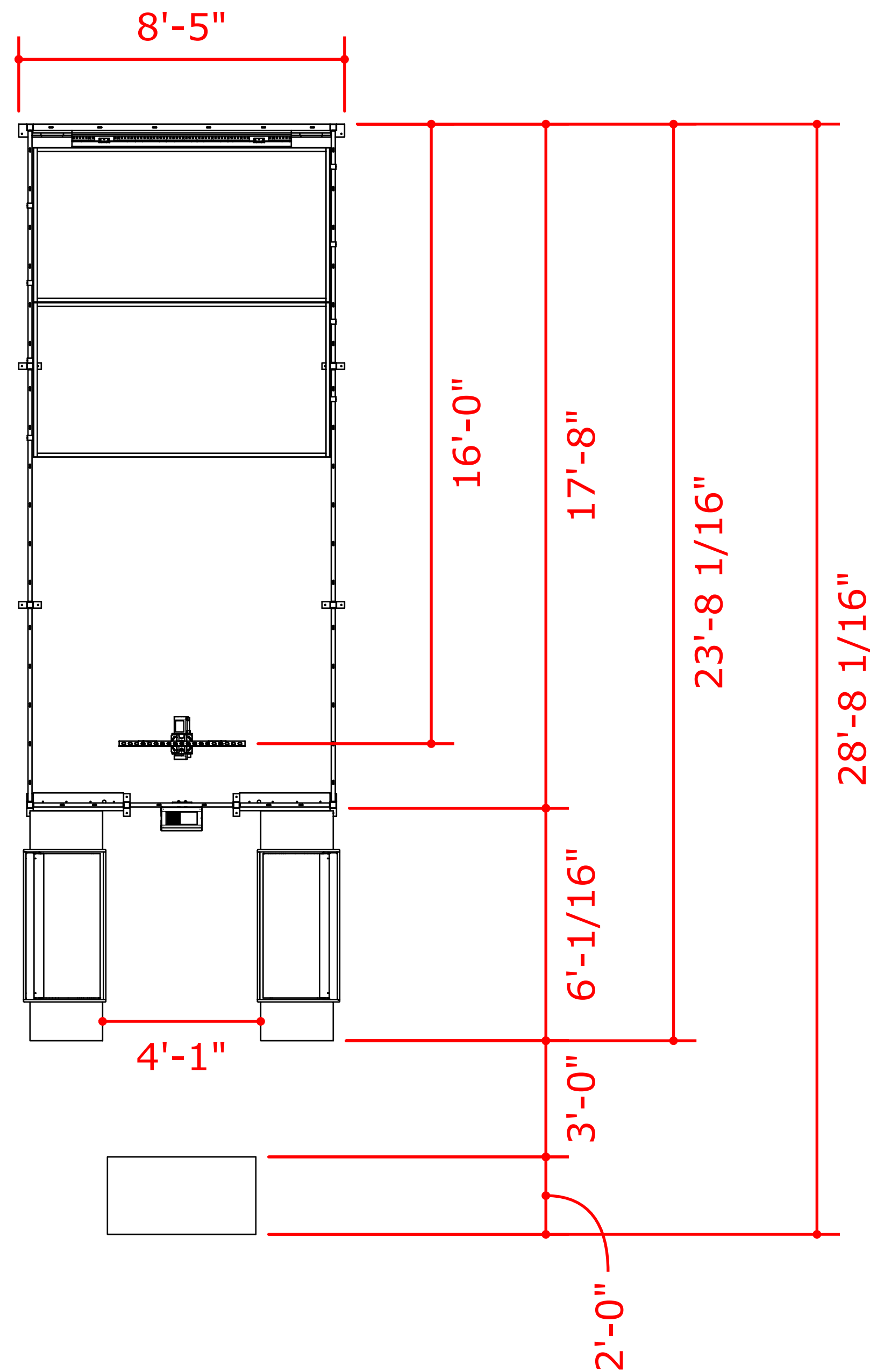

1-LANE - TOP-DOWN VIEW

SCALE 3/8" = 1'-0"

LASERTRON
DESIGNERS OF LASER TAG ARENAS AND FACILITIES

STEVE KESSLER
skessler@lasertron.us

12' 4" KRAZY AXES VIP

07-14-2025

2

- IMPORTANT NOTES:**
- KRAZY AXES VIP REQUIRES A MINIMUM OF 12' 6" CLEAR HEIGHT (DEPENDING ON CLEAR HEIGHT, SHORTER AXE LANES MAY BE AVAILABLE)
 - KRAZY AXES VIP REQUIRES A MINIMUM OF 2" TO THE RIGHT AND LEFT OF THE LANES FOR INSTALLATION.
 - THE 2" IS MEASURED FROM THE EDGE OF THE BASE PLATE TO THE NEAREST WALL.
 - KRAZY AXES VIP TYPICALLY INSTALLED TIGHT TO BACK WALL.
 - KRAZY AXES VIP LANES CAN BE OVERLAPPED TO CREATE 3-LANE, 4-LANE, 5-LANE, ETC...SIDE BY SIDE CONFIGURATIONS.

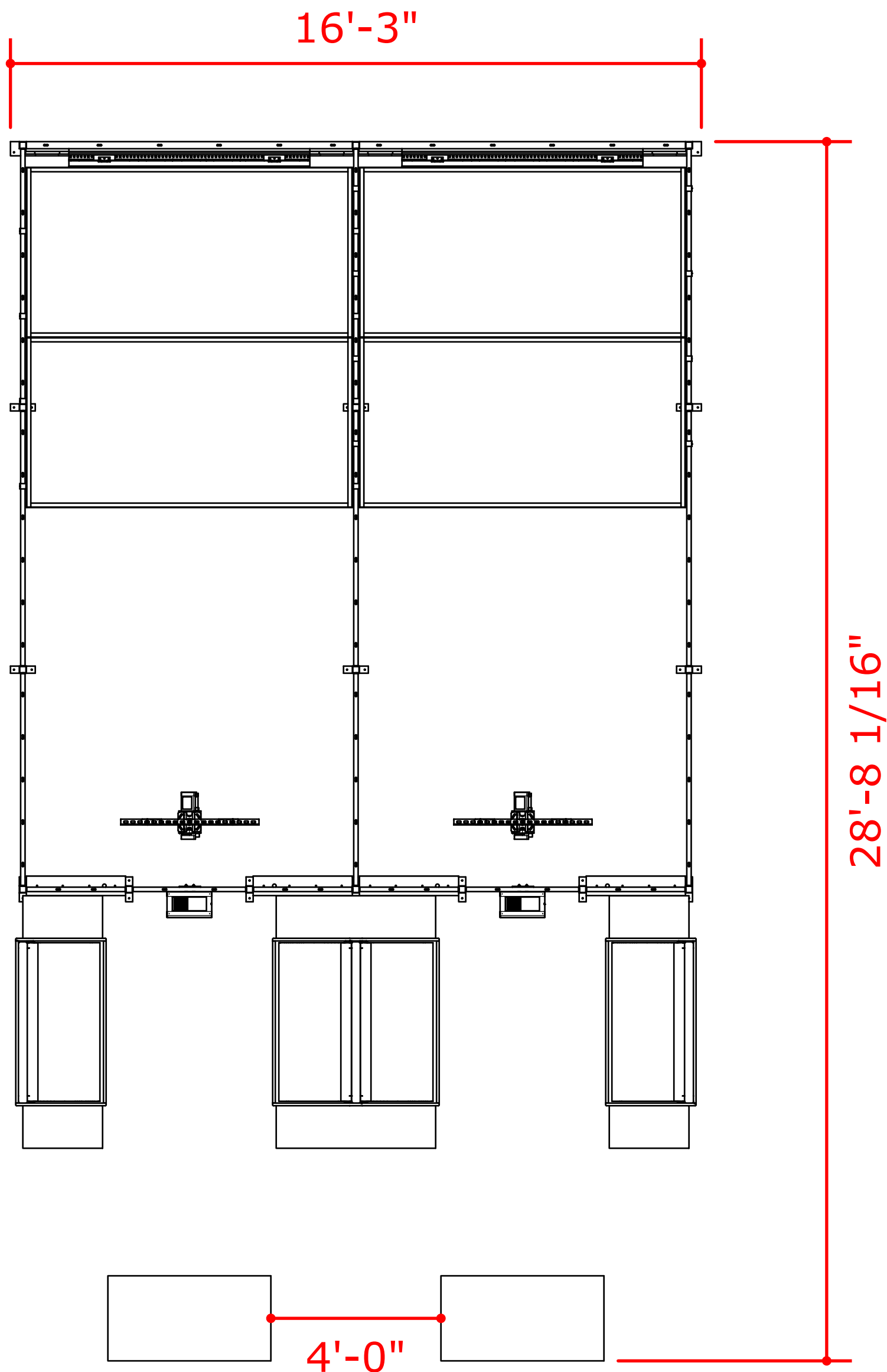

STANDARD FURNITURE PACKAGE

2-LANES - TOP-DOWN VIEW

SCALE 3/8" = 1'-0"

THIS DOCUMENT IS THE PROPERTY OF LASERTRON, INC. AND HAS BEEN PREPARED AND ISSUED FOR A SPECIFIC PROJECT AS MARKED ON THIS DOCUMENT. THE RECIPIENT BY ACCEPTING THIS DOCUMENT ASSUMES CUSTODY AND AGREES THAT THIS DOCUMENT WILL NOT BE COPIED OR REPRODUCED IN PART OR IN WHOLE. ALL SPECIAL FEATURES OF THIS DESIGN SHALL NOT BE INCORPORATED IN ANY OTHER PROJECT, UNLESS THE PRIOR WRITTEN AGREEMENT OF LASERTRON HAS BEEN OBTAINED. THIS DOCUMENT WILL BE RETURNED UPON THE COMPLETION OF THE PROJECT CONTEMPLATED BY THE DOCUMENTS OR UPON THE REQUEST OF LASERTRON. THIS DOCUMENT IS THE EXCLUSIVE PROPERTY OF LASERTRON, NO RIGHTS TO OWNERSHIP ARE TRANSFERABLE, OR SHALL BE LOST BY THE FILING OF THIS DOCUMENT WITH ANY AND ALL PUBLIC AUTHORITIES FOR ANY PURPOSES.

- IMPORTANT NOTES:**
- KRAZY AXES VIP REQUIRES A MINIMUM OF 12' 6" CLEAR HEIGHT (DEPENDING ON CLEAR HEIGHT, SHORTER AXE LANES MAY BE AVAILABLE)
 - KRAZY AXES VIP REQUIRES A MINIMUM OF 2" TO THE RIGHT AND LEFT OF THE LANES FOR INSTALLATION.
 - THE 2" IS MEASURED FROM THE EDGE OF THE BASE PLATE TO THE NEAREST WALL.
 - KRAZY AXES VIP TYPICALLY INSTALLED TIGHT TO BACK WALL.
 - KRAZY AXES VIP LANES CAN BE OVERLAPPED TO CREATE 3-LANE, 4-LANE, 5-LANE, ETC...SIDE BY SIDE CONFIGURATIONS.

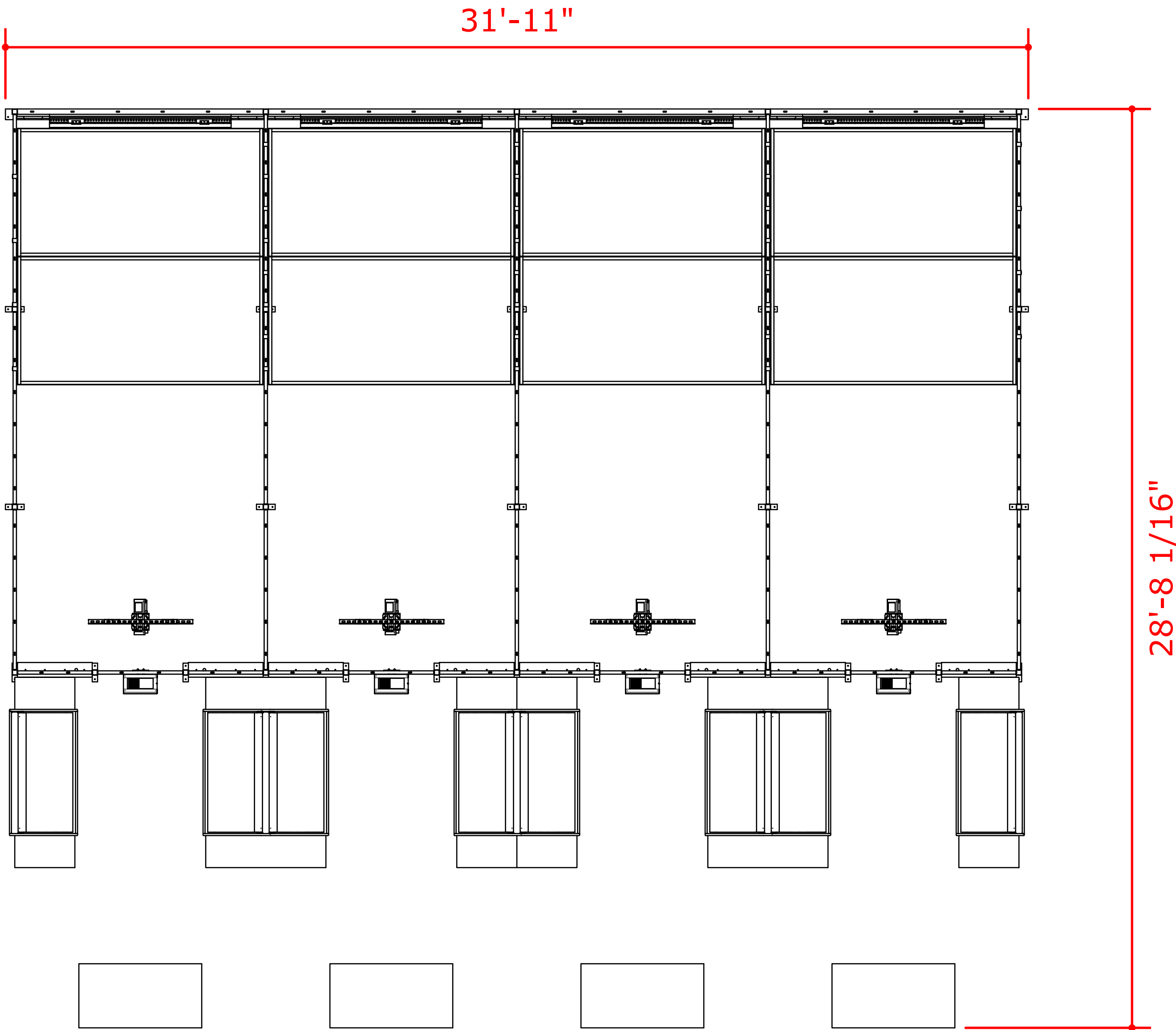

STANDARD FURNITURE PACKAGE

4-LANES - TOP-DOWN VIEW

SCALE 3/8" = 1'-0"

THIS DOCUMENT IS THE PROPERTY OF LASERTRON, INC. AND HAS BEEN PREPARED AND ISSUED FOR A SPECIFIC PROJECT AS MARKED ON THIS DOCUMENT. THE RECIPIENT BY ACCEPTING THIS DOCUMENT ASSUMES CUSTODY AND AGREES THAT THIS DOCUMENT WILL NOT BE COPIED OR REPRODUCED IN PART OR IN WHOLE. ALL SPECIAL FEATURES OF THIS DESIGN SHALL NOT BE INCORPORATED IN ANY OTHER PROJECT, UNLESS THE PRIOR WRITTEN AGREEMENT OF LASERTRON HAS BEEN OBTAINED. THIS DOCUMENT WILL BE RETURNED UPON THE COMPLETION OF THE PROJECT CONTEMPLATED BY THE DOCUMENTS OR UPON THE REQUEST OF LASERTRON. THIS DOCUMENT IS THE EXCLUSIVE PROPERTY OF LASERTRON, NO RIGHTS TO OWNERSHIP ARE TRANSFERABLE, OR SHALL BE LOST BY THE FILING OF THIS DOCUMENT WITH ANY AND ALL PUBLIC AUTHORITIES FOR ANY PURPOSES.

- IMPORTANT NOTES:**
- KRAZY AXES VIP REQUIRES A MINIMUM OF 12' 6" CLEAR HEIGHT (DEPENDING ON CLEAR HEIGHT, SHORTER AXE LANES MAY BE AVAILABLE)
 - KRAZY AXES VIP REQUIRES A MINIMUM OF 2" TO THE RIGHT AND LEFT OF THE LANES FOR INSTALLATION.
 - THE 2" IS MEASURED FROM THE EDGE OF THE BASE PLATE TO THE NEAREST WALL.
 - KRAZY AXES VIP TYPICALLY INSTALLED TIGHT TO BACK WALL.
 - KRAZY AXES VIP LANES CAN BE OVERLAPPED TO CREATE 3-LANE, 4-LANE, 5-LANE, ETC...SIDE BY SIDE CONFIGURATIONS.

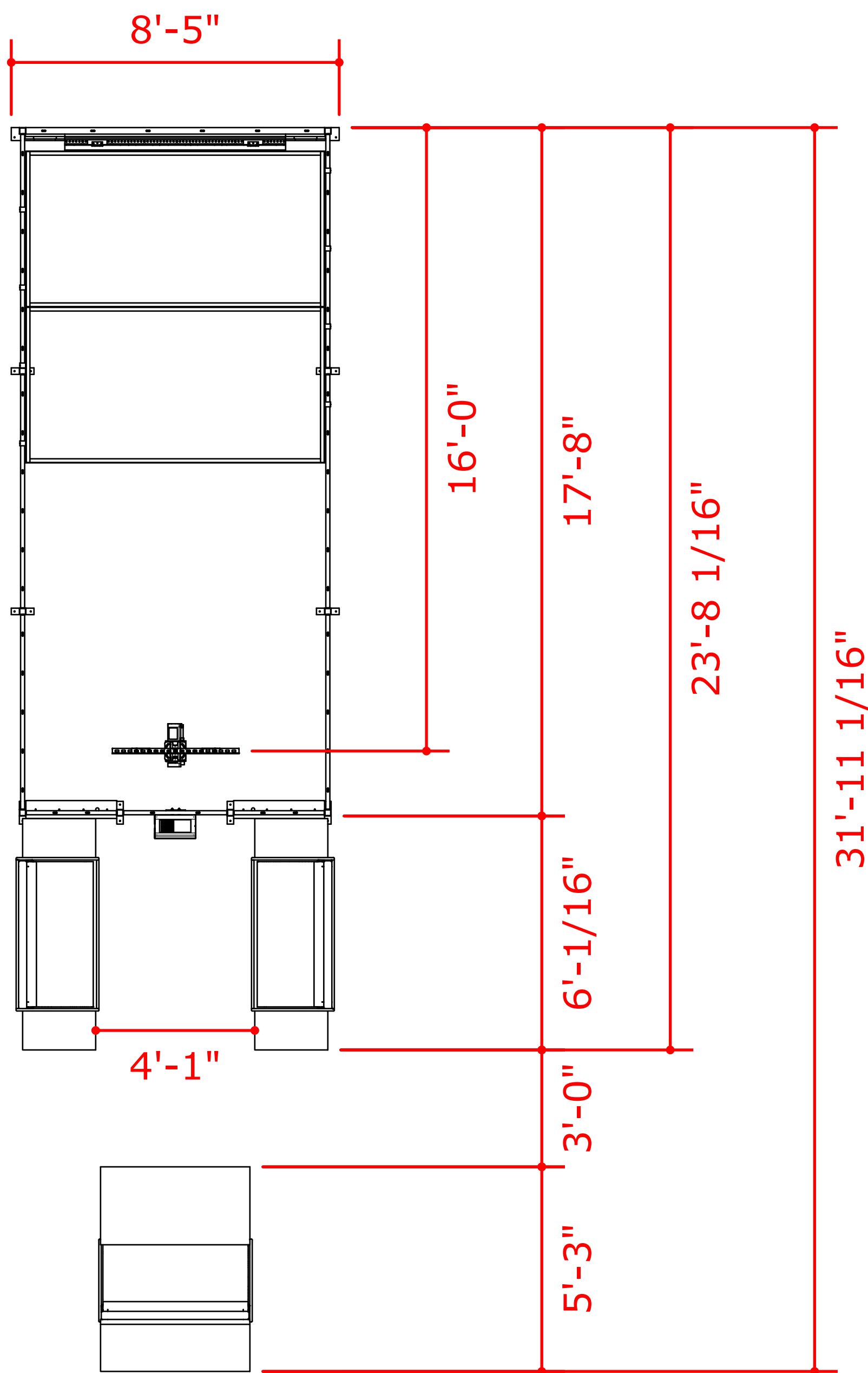

UPGRADED FURNITURE PACKAGE

1-LANE - TOP-DOWN VIEW

SCALE 3/8" = 1'-0"

THIS DOCUMENT IS THE PROPERTY OF LASERTRON, INC. AND HAS BEEN PREPARED AND ISSUED FOR A SPECIFIC PROJECT AS MARKED ON THIS DOCUMENT. THE RECIPIENT BY ACCEPTING THIS DOCUMENT ASSUMES CUSTODY AND AGREES THAT THIS DOCUMENT WILL NOT BE COPIED OR REPRODUCED IN PART OR IN WHOLE. ALL SPECIAL FEATURES OF THIS DESIGN SHALL NOT BE INCORPORATED IN ANY OTHER PROJECT, UNLESS THE PRIOR WRITTEN AGREEMENT OF LASERTRON HAS BEEN OBTAINED. THIS DOCUMENT WILL BE RETURNED UPON THE COMPLETION OF THE PROJECT CONTEMPLATED BY THE DOCUMENTS OR UPON THE REQUEST OF LASERTRON. THIS DOCUMENT IS THE EXCLUSIVE PROPERTY OF LASERTRON, NO RIGHTS TO OWNERSHIP ARE TRANSFERABLE, OR SHALL BE LOST BY THE FILING OF THIS DOCUMENT WITH ANY AND ALL PUBLIC AUTHORITIES FOR ANY PURPOSES.

- IMPORTANT NOTES:**
- KRAZY AXES VIP REQUIRES A MINIMUM OF 12' 6" CLEAR HEIGHT (DEPENDING ON CLEAR HEIGHT, SHORTER AXE LANES MAY BE AVAILABLE)
 - KRAZY AXES VIP REQUIRES A MINIMUM OF 2" TO THE RIGHT AND LEFT OF THE LANES FOR INSTALLATION.
 - THE 2" IS MEASURED FROM THE EDGE OF THE BASE PLATE TO THE NEAREST WALL.
 - KRAZY AXES VIP TYPICALLY INSTALLED TIGHT TO BACK WALL.
 - KRAZY AXES VIP LANES CAN BE OVERLAPPED TO CREATE 3-LANE, 4-LANE, 5-LANE, ETC...SIDE BY SIDE CONFIGURATIONS.

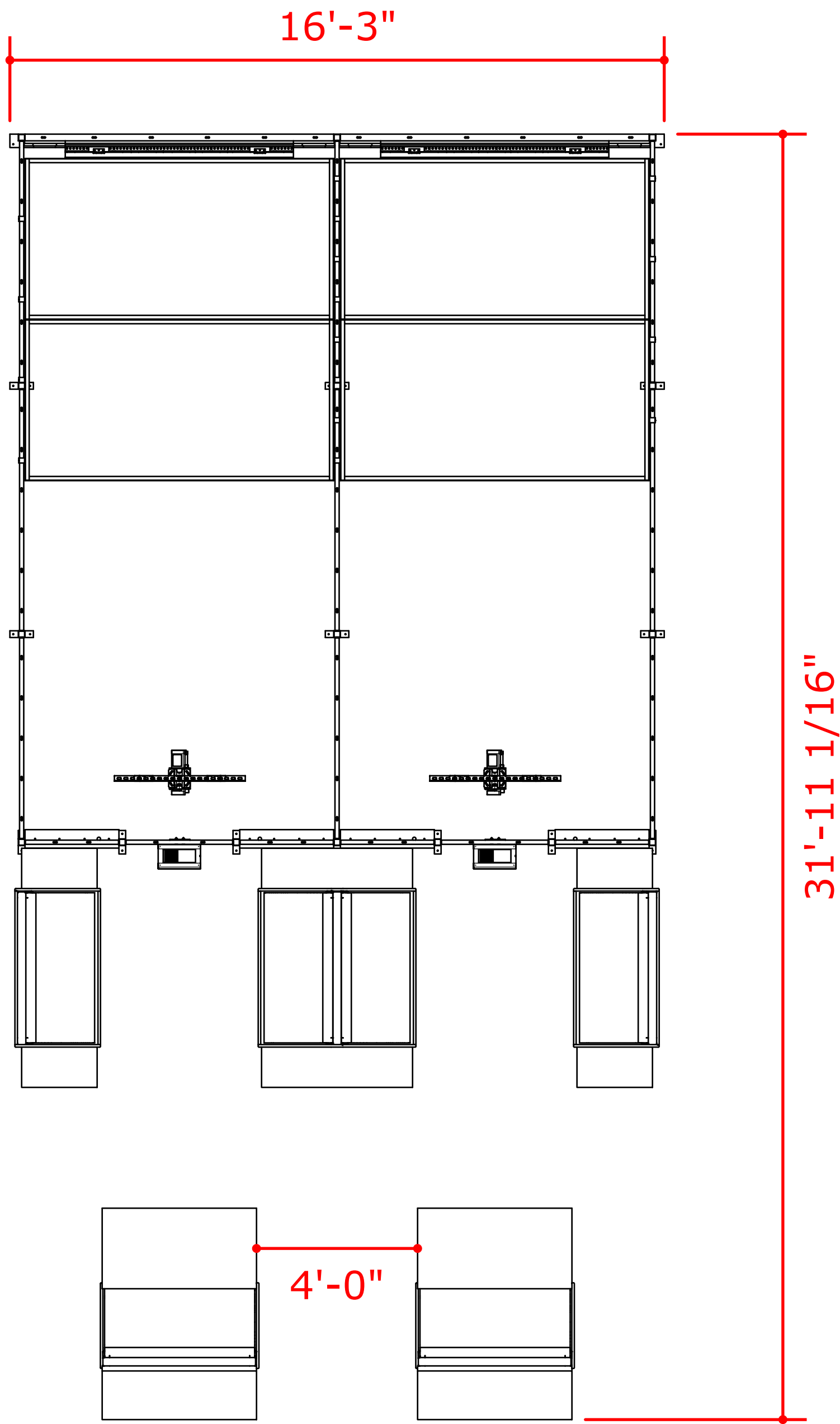

UPGRADED FURNITURE PACKAGE

2-LANES - TOP-DOWN VIEW

SCALE 3/8" = 1'-0"

THIS DOCUMENT IS THE PROPERTY OF LASERTRON, INC. AND HAS BEEN PREPARED AND ISSUED FOR A SPECIFIC PROJECT AS MARKED ON THIS DOCUMENT. THE RECIPIENT BY ACCEPTING THIS DOCUMENT ASSUMES CUSTODY AND AGREES THAT THIS DOCUMENT WILL NOT BE COPIED OR REPRODUCED IN PART OR IN WHOLE. ALL SPECIAL FEATURES OF THIS DESIGN SHALL NOT BE INCORPORATED IN ANY OTHER PROJECT, UNLESS THE PRIOR WRITTEN AGREEMENT OF LASERTRON HAS BEEN OBTAINED. THIS DOCUMENT WILL BE RETURNED UPON THE COMPLETION OF THE PROJECT CONTEMPLATED BY THE DOCUMENTS OR UPON THE REQUEST OF LASERTRON. THIS DOCUMENT IS THE EXCLUSIVE PROPERTY OF LASERTRON, NO RIGHTS TO OWNERSHIP ARE TRANSFERABLE, OR SHALL BE LOST BY THE FILING OF THIS DOCUMENT WITH ANY AND ALL PUBLIC AUTHORITIES FOR ANY PURPOSES.

- IMPORTANT NOTES:**
- KRAZY AXES VIP REQUIRES A MINIMUM OF 12' 6" CLEAR HEIGHT (DEPENDING ON CLEAR HEIGHT, SHORTER AXE LANES MAY BE AVAILABLE)
 - KRAZY AXES VIP REQUIRES A MINIMUM OF 2" TO THE RIGHT AND LEFT OF THE LANES FOR INSTALLATION.
 - THE 2" IS MEASURED FROM THE EDGE OF THE BASE PLATE TO THE NEAREST WALL.
 - KRAZY AXES VIP TYPICALLY INSTALLED TIGHT TO BACK WALL.
 - KRAZY AXES VIP LANES CAN BE OVERLAPPED TO CREATE 3-LANE, 4-LANE, 5-LANE, ETC...SIDE BY SIDE CONFIGURATIONS.

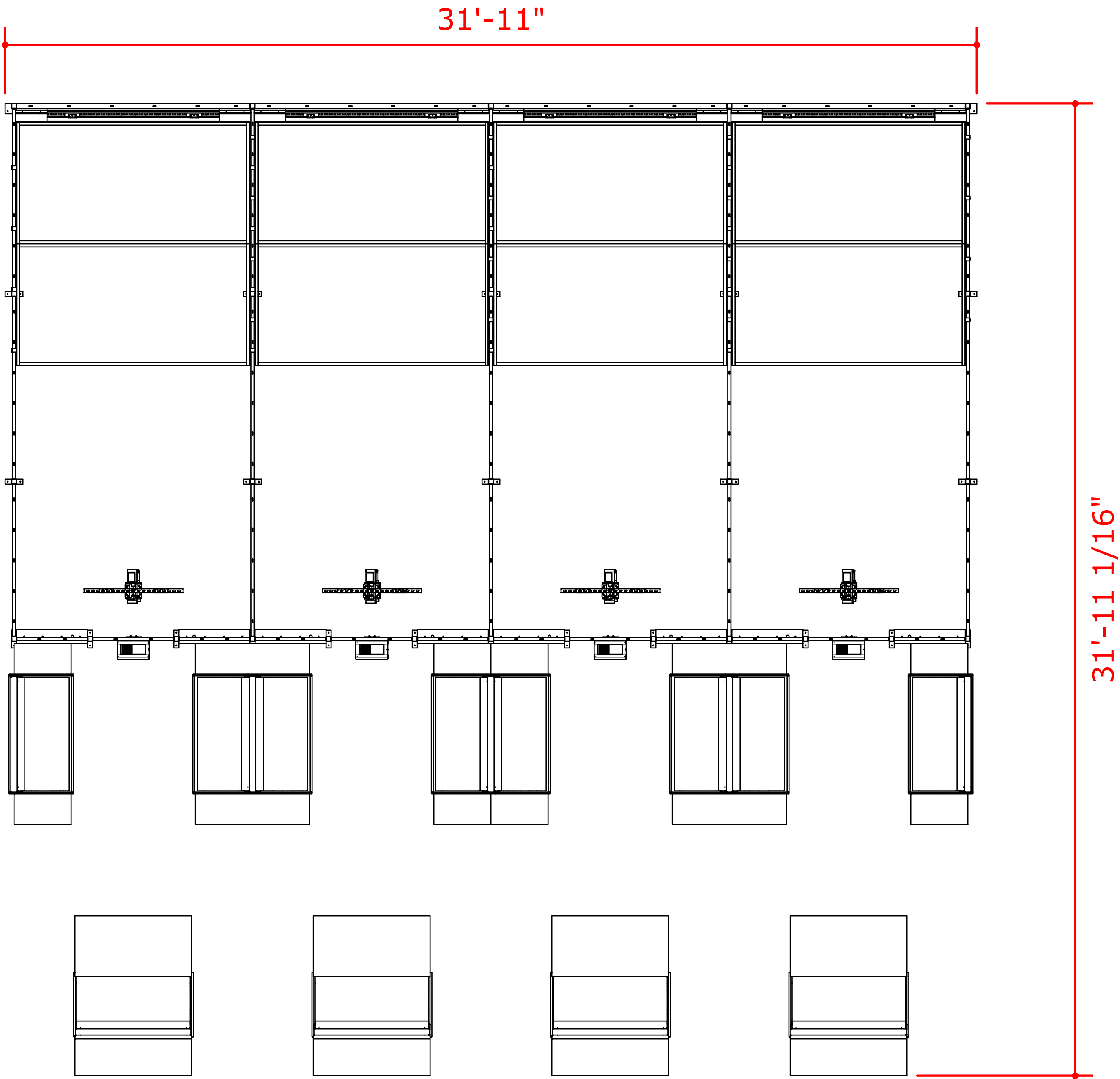

UPGRADED FURNITURE PACKAGE

4-LANES - TOP-DOWN VIEW

SCALE 3/8" = 1'-0"

THIS DOCUMENT IS THE PROPERTY OF LASERTRON, INC. AND HAS BEEN PREPARED AND ISSUED FOR A SPECIFIC PROJECT AS MARKED ON THIS DOCUMENT. THE RECIPIENT BY ACCEPTING THIS DOCUMENT ASSUMES CUSTODY AND AGREES THAT THIS DOCUMENT WILL NOT BE COPIED OR REPRODUCED IN PART OR IN WHOLE. ALL SPECIAL FEATURES OF THIS DESIGN SHALL NOT BE INCORPORATED IN ANY OTHER PROJECT, UNLESS THE PRIOR WRITTEN AGREEMENT OF LASERTRON HAS BEEN OBTAINED. THIS DOCUMENT WILL BE RETURNED UPON THE COMPLETION OF THE PROJECT CONTEMPLATED BY THE DOCUMENTS OR UPON THE REQUEST OF LASERTRON. THIS DOCUMENT IS THE EXCLUSIVE PROPERTY OF LASERTRON, NO RIGHTS TO OWNERSHIP ARE TRANSFERABLE, OR SHALL BE LOST BY THE FILING OF THIS DOCUMENT WITH ANY AND ALL PUBLIC AUTHORITIES FOR ANY PURPOSES.